



HOPE'S

AUCTIONEERS

STINT AND GRASS LETTING CATALOGUE

WEDNESDAY 26TH MARCH 2025

SALE OF COMPANY SHARES AT 7PM

FOLLOWED BY

ANNUAL LETTING OF STINTS

**on Burgh, Newton Arlosh & Saltcoats and
Skinburness & Calvo Marshes**

followed by

LETTING OF GRASSLAND

FOR THE 2025 SEASON

WITHIN THE TIFFENTHWAITE RING, HOPES AUCTION MART AT 7PM

**PAYMENT FOR RENT AND SIGNING OF
AGREEMENTS MUST TAKE PLACE AT THE LETTINGS**

**PLEASE NOTE WE CAN ONLY ACCEPT CHEQUES, BACS OR PERSONAL BANK CARDS
– BUSINESS BANK CARDS WILL BE ACCEPTED BUT WILL INCUR A 2% SURCHARGE**



GENERAL CONDITIONS FOR LETTING OF GRASSLAND

1. The last and highest accepted bidder shall be the Grazier
2. No grazier shall be allowed to sub-let any lot.
3. The owner of the land will licence the Grazier to use the land from the date of the letting until the date stated for each lot.
4. All cattle must be properly ear-tagged.
5. The Grazier to accept the terms of the Grazing Agreement and sign the Agreement on the day of letting and to pay monies due at the same time.
6. No land to be strip grazed except by consent of the owner. No land to be grazed with dairy cows except by consent of the owner. **No stock suffering from any contagious disease and no bulls, horses or other unruly or rambling animals** to be put on the land unless permission is given in writing. No stock to be driven home at nights out of any of the land without the permission of the owner.
7. Any person who makes a bid for a lot which is accepted by the Auctioneers agrees in consideration of the Auctioneers accepting his bid that the conditions contained herein shall govern his rights and liabilities to the Auctioneers and to the owner.
8. The Auctioneers and their servants and agents shall not be liable for injury, loss or damage howsoever caused and whether by negligence or otherwise.
9. **TAKERS OF THE LAND SHALL PAY RENT IN FULL TO THE AUCTIONEERS AT THE LETTING AND SIGN THE AGREEMENT.**
10. The measurement of all lots to be taken as correct and no abatement of rent to be made.
11. The Grazier to accept all hedges, gates and ditches in their present condition and leave the same in good order at the end of the term.
12. The Game is reserved
13. The Owner will pay all rates and taxes.
14. The Owner and the Auctioneers do not hold themselves in any way responsible for loss or accident that may occur to any animal grazing the said land.
15. Please note land is let for mowing and/or grazing, as described for each lot.
16. If the land is let as fertilised this means that the owner is to fertilise the land and spread lime and the owner is to decide when and how much should be put on.
17. If the land is let as non-fertilised this means that the grazier shall not fertilise the land, but if he does so then he fertilises as contractor for the owner.
18. Where a Dipping Tub is made available for use, this does not include the right to dispose of the dip on the land taken. The taker of the land is responsible for contacting the Environment Agency to obtain the legal required consent for the disposal of the dip on their own land.
19. Should any dispute arise in respect of any damages by reason of non-observance of any Conditions by the Owner or by any tenant taking the said lands, the said dispute to be referred to the Auctioneer, whose decision shall be binding on both Owner and Tenant and shall not be subject to review by any Court of Law or Equity, any law or custom to the contrary notwithstanding.
20. Should any person or persons neglect or refuse or fail to comply with the foregoing Conditions his or her Lot or Lots will be re-let either by Public Auction or Private Contract, and the deficiency (if any) occasioned by such second letting together with all costs and expenses attending the same shall be a debt to be recovered from and made good by the defaulter at this present letting, but any surplus arising out of such second letting shall be retained by the Auctioneer for his own benefit.

21. The Auctioneer conducting the Auction shall be deemed to be authorised by both the Licensor and the Licensee to sign a Licence containing the foregoing Conditions and embodying therein the names of the parties, the dates of the commencement and termination of the Licence, the rent, and the particulars of the land, together with any Special Conditions affecting the Licence. In the event of any inconsistency between such Special Conditions and the foregoing, Conditions and Special Conditions shall prevail.

Plans and Grazing Agreements are available for inspection at the Auction Mart Office (by appointment please telephone 016973 42202)

Nothing in these terms shall be deemed to derogate from the rights of the owner and all persons authorised by the owner to enter the land at all times for purposes not inconsistent with this licence and they carry out such purposes.

TB MOVEMENT REGULATIONS

For cattle moving to grassland situated in a 4-year Testing Plan

Cattle over 42 days of age from a herd which has a One- or Two-Year Testing Plan will need to be pre-movement tested before they can move to the Grassland. Cattle going from a 4-year Testing Plan herd do not need to be tested prior to moving.

Please see further information on forthcoming pages for movement to stints.

For cattle moving to grassland situated in a 1 year or 2-year Testing Plan

Cattle over 42 days of age from a herd which has a One- or Two-Year Testing Plan will need a pre-movement test and a further test before returning home. Cattle from a herd with a 4-year Testing Plan can go without testing but will need to be tested before returning home.

All tests are to be done at the expense of the owner of the cattle unless it falls within their normal testing period.

Anyone with further queries on testing and movement please contact the Animal Health Office on Telephone number 03000 200 301 or your own Veterinary Surgeon.

LAND USED ON A TEMPORARY BASIS

If you take on new land on a temporary basis for livestock you need to apply to APHA to register it (<https://www.gov.uk/government/publications/apply-to-register-temporary-use-of-land-to-keep-livestock>)

If you use land on a temporary basis (that is, for one year or less) to keep livestock, you have the following two options to consider - either a TLA or tCPH which you apply to APHA for:

- If you have the sole occupancy of the land (that is, your livestock will not be mixing with livestock kept by someone else) you may apply for a Temporary Land Association (TLA) or a Temporary CPH (tCPH) number.

TEMPORARY LAND ASSOCIATION

If this land is **within ten miles**, you can apply to APHA to associate the land via a TLA. A TLA will last up to a year (with an option to renew), during which time the land covered would be treated as part of your permanent CPH for livestock recording and reporting purposes and disease control. This means that:

- Movements to that land from other land covered by your permanent CPH would not need to be recorded or reported and would not trigger a standstill.
- Movements to that land from a different CPH would need to be recorded and reported against your permanent CPH.
- Moves reported to a CPH will trigger standstill on all of the land it covers including any land temporarily associated with it.
- All land covered by a single CPH, whether temporarily or permanently, will be treated as part of that CPH from a disease testing and restriction perspective.

If a CPH is registered for keeping bovine animals (cattle, buffalo, or bison) a TLA will only be permitted where the land is in the same TB risk area as that of the CPH to which it is to be associated.

TEMPORARY CPH (tCPH)

You can apply for a tCPH to cover one or more pieces of land intended to be used for 12 months or less, and where you need an additional CPH number for livestock movement reporting purposes. You can get a tCPH regardless of the distance between it and any other CPH's that you hold, so long as livestock on the different holdings do not mix. They will last up to a year (with an option to renew) during which time the same statutory livestock movement recording, reporting and standstill requirements would apply as to a permanent holding.

In summary:

- A separate holding register has to be kept for a tCPH.
- All livestock movements on and off land covered by a tCPH number, including movements between a tCPH and any other CPHs you hold, must be recorded, and reported.
- All livestock movements on or off a tCPH would trigger standstill on the receiving holding, including movements to/from your permanent CPH(s)
- Livestock on a tCPH must be kept separate from those of any other keeper and from any other CPH(s) that you hold.
- For most disease control purposes – testing, or movement restrictions – the land included in a tCPH will be treated (subject to APHA veterinary risk assessment) as part of that tCPH and not as part of your permanent holding or that of the person you are renting the land from.

These rules are correct at the time of printing but if legislation changes all takers of stints and grassland must comply with rules currently in force.

BURGH MARSH

Burgh Marsh is currently on a TB 1-year testing pattern.

- Cattle going to the Marsh will need to be pre-movement tested if the premises they are leaving is on a 1- or 2-year pattern.
- The cattle will go onto the Marsh on Tuesday 6th May and be removed on Friday 17th October 2025.
- **Stints are for cattle only. One beast to one stint.**
- Marsh let for accredited cattle - maiden heifers or bullocks.
- PLEASE NOTE – IT IS THE OWNERS RESPONSIBILITY TO CHECK THAT ALL BULLOCKS ARE CASTRATED PROPERLY PRIOR TO ENTERING THE MARSH
- **ANY HEIFER FOUND IN CALF MUST BE REMOVED IMMEDIATELY.**
- All cattle must be properly ear tagged with tags provided by The Committee and ear tag numbers give to the Marsh Herd when stock is taken to the marsh.
- Cattle will be inspected by Committee members upon arrival.
- No gathering of stock at weekends.
- The common CPH for Burgh Marsh is 00/000/6050.
- Burgh Marsh is registered Common Land under the Commons Registration Act 1965.
- Due to the removal of links, graziers using Burgh Marsh must contact BCMS on 0345 050 1234 to confirm they are using common land.
- The TB testing pattern on the marsh has changed. Please see below for details
 - Users of the marsh will be required to undertake RAD testing (Radial TB testing in the Low risk Area of England TB I TB hub). If not already within the current RAD zone (e.g. herds outside the current RAD zone will be brought into RAD testing regime) – eligible for pre-movement testing.
 - Users of stints will need to get an additional CPH for their marsh cattle and link this to their farm CPH.
 - There will be no need to pre-movement test before sending or bringing cattle from the common to the main premises – all tests will be carried out back at the main holding. NB. This is unless the main holding is under a different TB1 testing regime to the Marsh, when cattle will need to be tested before coming to the marsh.
 - Licences will be issued before the cattle leave the Marsh to authorise movement back to the main holding where they will be tested.
 - The above rules only apply to cattle, not for sheep.
 - Before any cattle are put on marsh The Field Reeve must be provided with CPH, cattle numbers (numbers on passport) and corresponding management tag numbers.

For any queries please contact The Marsh Field Reeve, Jane Hodgson 07762286050

NEWTON ARLOSH AND SALTCOATS MARSH

This Marsh is currently on a 4-year TB Testing Pattern.

- Cattle moving to the Marsh from a 1-year testing pattern will need to be pre-movement tested within 60 days of the movement.
- **The Marsh is let for Maiden Heifers and Bullocks only.** All bullocks will be checked by committee members.
- **ANY HEIFER FOUND TO BE IN CALF MUST BE REMOVED IMMEDIATELY. REPLACEMENTS ARE ALLOWED AT A CONVENIENT DAY AND TIME WITH THE MARSH HERD.**
- All stock taken to the Marsh must be properly ear tagged and a list of numbers given to the Marsh Herd.
- No stock to be removed without the Herds permission.
- **TWO CATTLE TO ONE STINT**
- To be stinted on Tuesday 6th May 2025 between 10.00 am and 3.00 pm, and to be removed on Friday 17th October 2025.

Any queries please contact the Marsh Secretary – Mrs Rosemary Bell on 016973 52399.

SKINBURNNESS AND CALVO MARSH

This Marsh is on a 4-year TB testing pattern.

- This Marsh is open to cattle from one- and four-year testing patterns, however cattle from farms which are currently within a TB restricted area will need to be tested within 60 days prior to moving to the marsh. Confirmation of the results should be shown to the Marsh herd on stinting day.
- **All stock to be properly ear tagged and a list of their ear numbers given to the marsh herd when the stock is taken to the marsh.**
- No stock to be removed without the herds permission and supervision.
- No in-calf cattle allowed, only **non-pregnant** maiden heifers and bullocks over six months old. All bullocks will be checked on site by committee members before being allowed onto the marsh. Any Heifers deemed to be in calf throughout the season, the committee reserves the right to have a vet to PD them.
- Any person renting or buying stints must agree to abide by the Higher-Level Stewardship Agreements which the marsh is subject to.
- Marsh Herd is Paul Storr, telephone 07966 717594.
- 1 beast to 1 stint
- 2 ewes and 4 lambs to one stint
- 4 geld sheep to 1 stint (from August 4 sheep or 4 lambs to 1 stint)
- **Stock to be brought to the Marsh between 9.00 am and 3.00 pm on Thursday 1st May 2025.** Other times by prior arrangement with the Marsh Herd only.
- **Stock to be removed on Friday 31st October 2025.**
- First change of stock – second week in August, subject to tides
- Second change of stock – second week in September – subject to tides

Any queries please contact the Marsh Secretary – Mrs Tanya Brown Tel. 016973 61277 or 07972 298723

Immediately after the Letting of Stints

**LETTING OF GRASS LAND IN THE FOLLOWING
ORDER:**

Mrs V Eilbeck
Holme Low Parish Council
Hopes Auction Co Ltd
Messrs Strickland
Mr J Scott

Banklands, Mealsgate, Wigton
Land Adjoining Cow Lane, Silloth
Auction Land
Land at Rash Farm, Ireby
Land at Hayton

GRASS LETTING TO BE HELD ON THE PREMISES:

Thursday 10th April 2025

For JW Bowman & Sons
Please meet at Tensend, Ivegill at 6.00pm

Followed by
For Mr & Mrs G & A Brown
Please meet at Bartons Farm, Thomas Close, CA11 9QF at 7.00pm

Friday 11th April 2025

For Mr Neil Holliday
Please meet at Sewell House, Ivegill at 5.45pm

Followed by
For Mr N Holliday
Please meet at Skelton Pasture, Penrith at 7.00pm

***ALL AGREEMENTS TO BE SIGNED AND
RENT PAID AT THE LETTINGS.***

For Mrs V Eilbeck

BANKLANDS, MEALSGATE, WIGTON

Lot	Map Sheet	OS	Ha.	Acres
1 Whitehall Park	NY1944	9755	9.14	22.58
2 Dow Park	NY1941	8971	3.02	7.46
3 Whitehall Church Park	NY2041	1882	11.37	28.09
4 Opposite West Lodge etc.	NY2041	2147	1.08	2.66
	NY2041	2870	0.94	2.32
	NY2041	3774	<u>0.32</u>	<u>0.79</u>
		TOTAL	2.34	5.77
5 Front Park	NY2041	3553	3.67	9.06
6 Front Park Behind Bungalow	NY2041	5071	4.25	10.50
7 Behind Farm Buildings	NY2041	4890	2.29	5.65
8 Wharrels Field	NY1637	5775	3.72	9.19
	NY1637	9091	<u>9.34</u>	<u>23.07</u>
		TOTAL	13.06	32.26

Let for cattle from 7th April 2025 until 1st November 2025 and sheep from 1st April 2025 until 31st December 2025.

NO BULLS, NO HORSES ALLOWED

No fertilizer will be applied, although taker can apply fertilizer.

Winter free.

Well-watered and fenced.

Right of way through Lot 2 to Lot 3 for movement of stock.

Public footpath through Lot 7.

Lots 1-8 are let for cattle and sheep only.

Loading pens and dosing facilities are available.

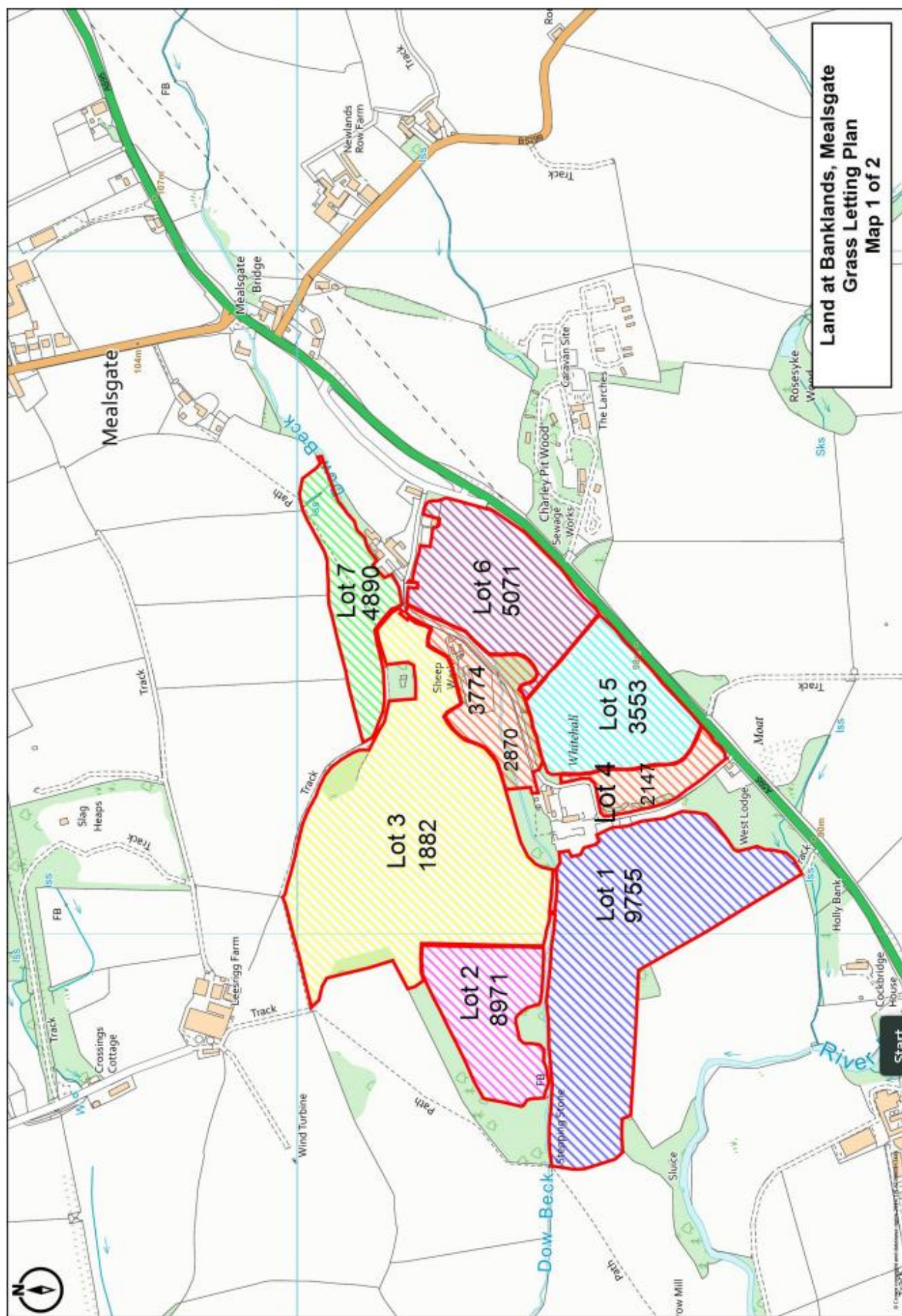

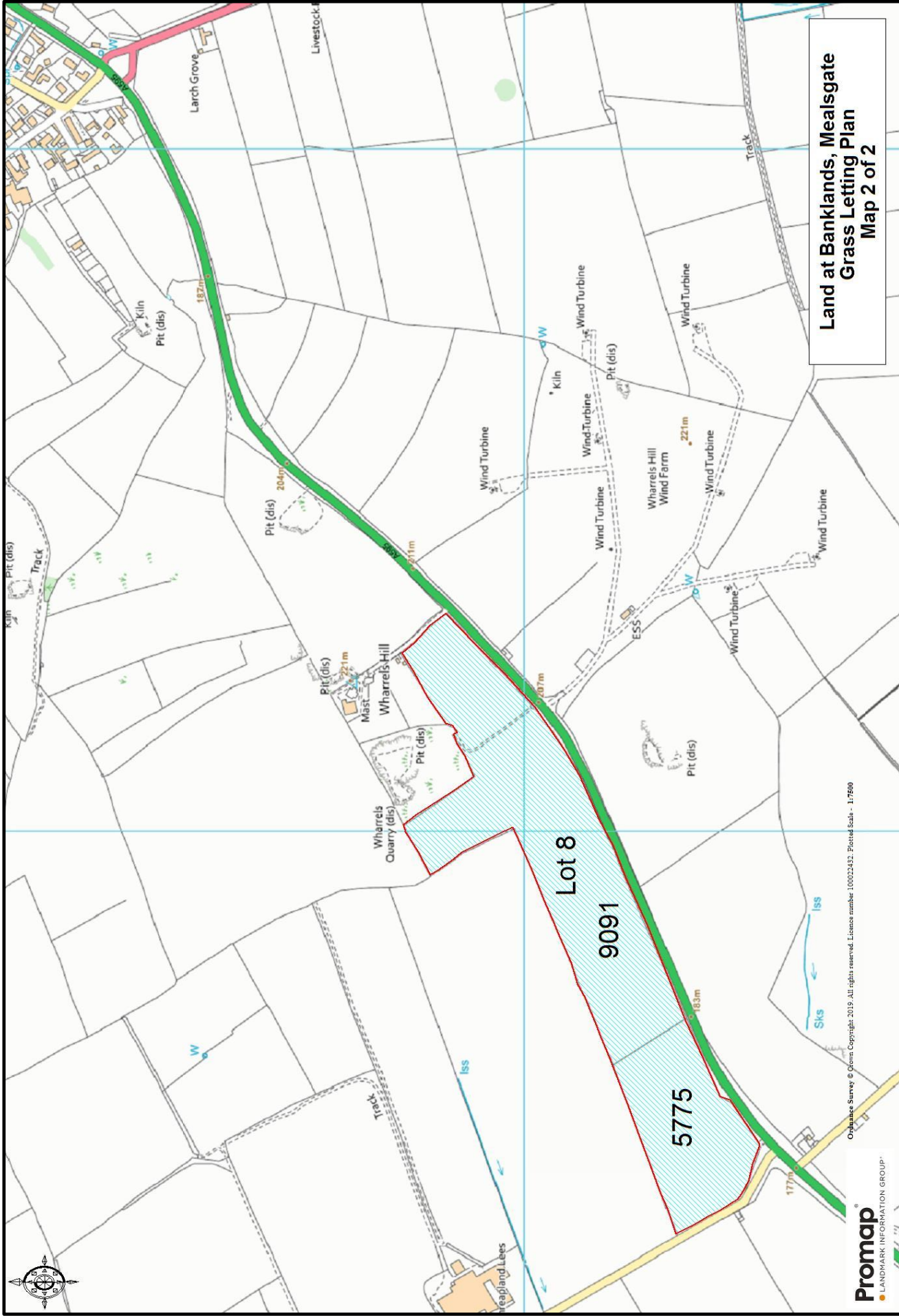

Land at Banklands, Mealsgate
Grass Letting Plan
Map 2 of 2

Lot 8

9091

5775

Ordnance Survey © Crown Copyright 2019. All rights reserved. Licence number 10002432. Printed Scale - 1:7500

For Holme Low Parish Council

C/o W Jameson, 5 Burnswalk Terrace, Solway Street, Silloth

LAND ADJOINING COW LANE, SILLOTH

Lot	Map Sheet	OS	Ha.	Acres
1	NY1252	8689	0.58	1.44

Fertilizer will not be applied.

Taker can apply fertilizer if required.

No horses allowed. No bulls allowed.

Let for Cattle only from 30th March 2025 until 1st November 2025.

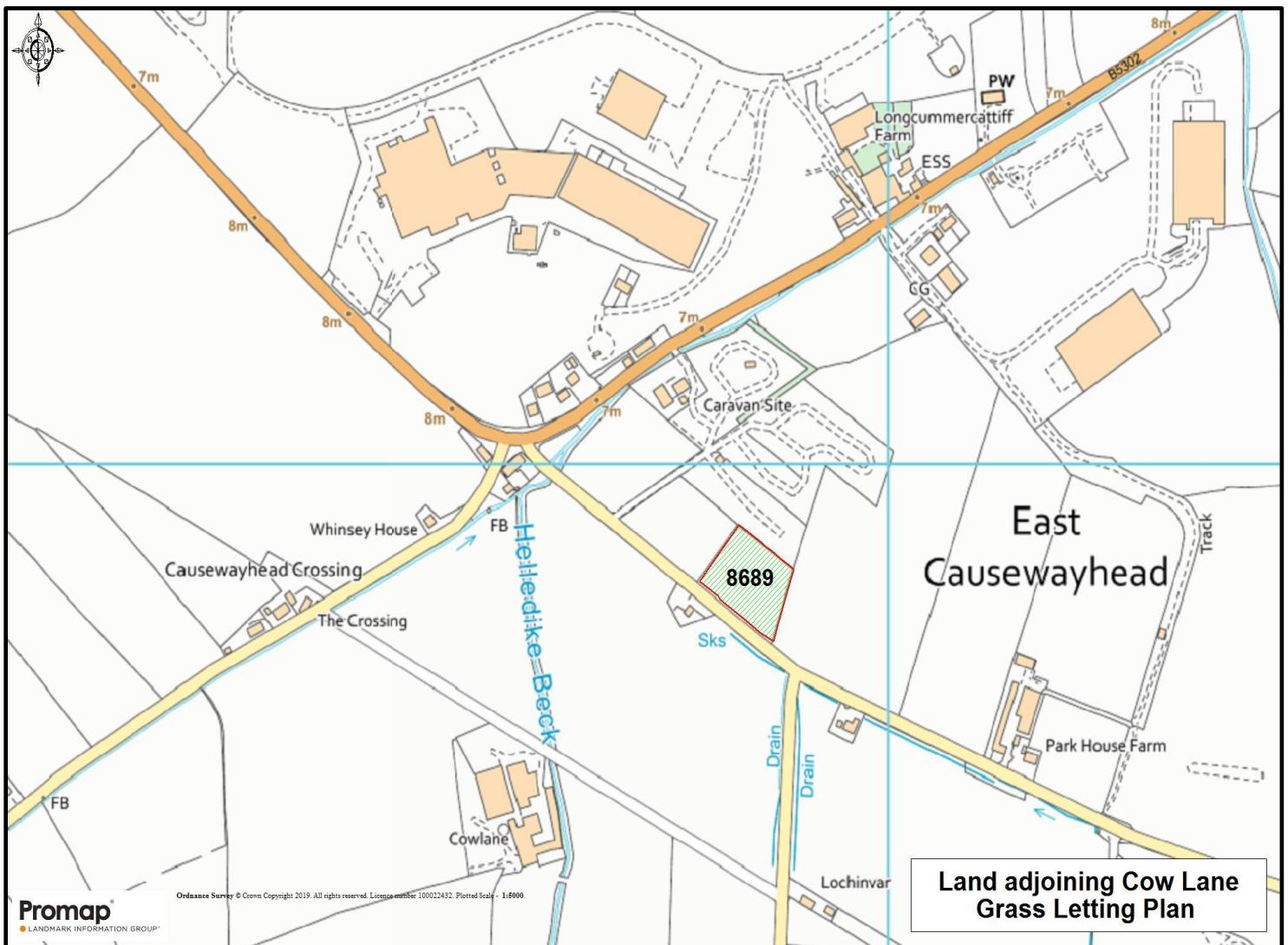

For Hopes Auction Company Ltd

AUCTION LAND

Lot	Map Sheet	OS	Ha.	Acres
1. Top Cemetery Field	NY2448	4777	4.32	10.67
	NY2448	6358pt	<u>2.26</u>	<u>5.58</u>
		TOTAL	6.58	16.25
2. Butchers Field	NY2548	2595	0.93	2.30
3. Bowling Field	NY2548	1502pt	0.97	2.42
	NY2548	3016	0.23	0.56
	NY2548	3314	<u>1.10</u>	<u>2.71</u>
		TOTAL	2.30	5.69

Let on the understanding that the grazing period can be terminated subject to giving 4 weeks' notice to take the land back in hand. If the land is taken back in hand the rental amount will be refunded on a pro-rata basis.

Let for cattle and sheep.

No Bulls

Let for cattle from 2nd April 2025 until 31st October 2025

Let for sheep from 2nd April 2025 until 30th November 2025.

All Lots have a water supply.

1 cwt 34.5% Nitrogen will be applied.

A single cut of silage can be taken from all lots, if any field is mowed then slurry is to be applied.

Handling facilities are available in Lot 1.

All takers are responsible for the maintenance of water troughs during the grazing season.

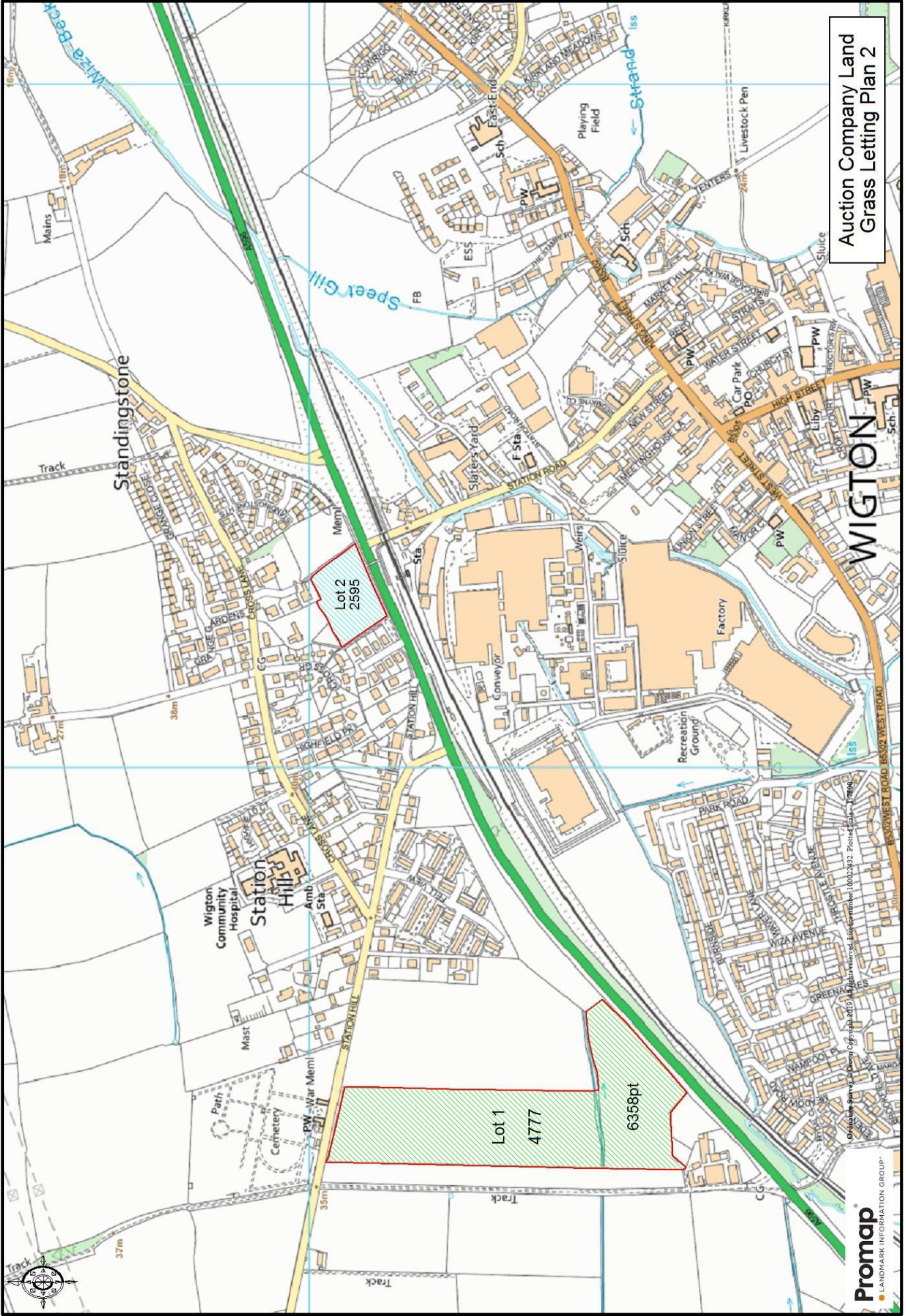

Auction Company Land
Grass Letting Plan 2



**Auction Company Land
Grass Letting Plan 1**

Ordnance Survey © Crown Copyright 2019. All rights reserved. Licence number 10002432. Printed Scale - 1:5000

For Messrs Strickland

LAND AT RASH FARM, IREBY

Lot	Map Sheet	OS	Ha.	Ac
1	NY2439	9325	5.18	12.80
2	NY2539	1021	3.72	9.19
	NY2539	2018	<u>0.95</u>	<u>2.34</u>
TOTAL			4.67	11.53
3	NY2538	2198	5.78	14.28

Let for cattle and sheep.

1st April 2025 until 31st October 2025 for Cattle and

1st April 2025 until 31st December 2025 for Sheep.

Lot 1 and 2 can be mowed once.

Main's water to Lot 1 and 2. Water from a river for Lot 3.

Fertiliser will not be applied.

Taker can apply fertiliser if required.

Handling facilities are available at the farm by arrangement.

No Bulls, No Horses allowed

Winter free

Land will be rolled

Land will be mucked, weather permitting



For Mr Jim Scott

LAND AT HAYTON, ASPATRIA

Lot	Map Sheet	OS	Ha.	Acres
1	NY1041	2837	2.71	6.69
TOTAL			2.71	6.69

Let for cattle and sheep.

No Horses or Bulls allowed

31st March 2025 until 31st October 2025 for Cattle and/or Sheep

Taker to apply fertiliser if required.

Taker to pay for water and up keep the fences.



LETTING OF GRASSLAND ON THE PREMISES

On Thursday 10th April 2024 at 6pm

For

**Messrs JW Bowman & Sons, Temsend, Ivegill, Carlisle,
CA4 0QE**

Lot	Map Sheet	OS	Ha	Acres
1	NY4041	8094	<u>1.18</u>	<u>2.91</u>
		TOTAL	1.18	2.91
2	NY4041	6384	<u>2.41</u>	<u>5.95</u>
		TOTAL	2.41	5.95
3	NY4042	9207	1.03	2.55
	NY4142	1217	<u>2.58</u>	<u>6.37</u>
		TOTAL	3.61	8.92
4	NY4042	8816	3.54	8.75
	NY4142	0233	<u>4.25</u>	<u>10.50</u>
		TOTAL	7.79	19.25
5	NY4042	6603	3.17	7.83
	NY4041	5293	<u>3.22</u>	<u>7.95</u>
		TOTAL	6.39	15.78

All lots let from 10th April 2025 until 31st October 2025

Let for both Cattle and Sheep

Cattle from 10th April until 30th September 2025

Sheep from 10th April until 31st October 2025

Taker to herd own stock

Unfertilised

No mowing of the land

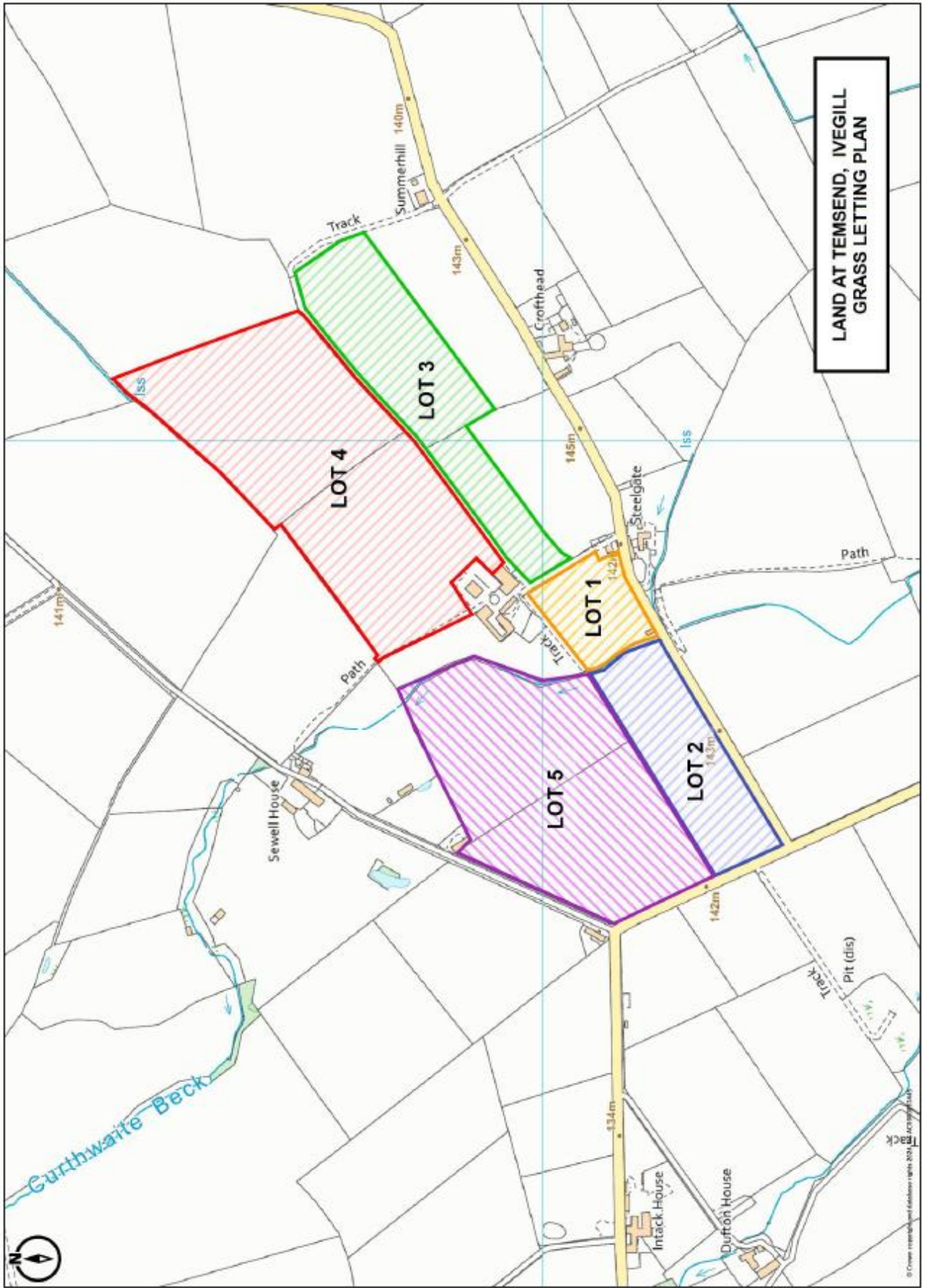

LETTING OF GRASSLAND ON THE PREMISES

On Thursday 10th April 2025 at 7pm

For

G & A Brown, Bartons Farm, Thomas Close, Penrith, CA11 9QF

Lot	Map Sheet	OS	Ha	Acres
1	NY4340	3340	2.25	5.55
2	NY4340	4628	1.80	4.44
	NY4340	5215	<u>2.80</u>	<u>6.91</u>
		TOTAL	4.60	11.35
3	NY4340	3413	3.71	9.16
	NY4339	4492	<u>4.39</u>	<u>10.84</u>
		TOTAL	8.10	20.00
4	NY4339	5679	2.68	6.62
	NY4339	3868	<u>2.97</u>	<u>7.33</u>
		Total	5.65	13.95
5	NY4339	1655	5.42	13.39
6	NY4339	2481	3.93	9.71
7	NY4339	0871	3.80	9.39
8	NY4239	9890	4.68	11.56
9	NY4339	1789	4.42	10.92
10	NY4240	8709	4.94	12.20
11	NY4340	0820	2.93	7.24
12	NY4340	2023	1.15	2.84

All lots let from 11th April 2025 until 31st October 2025 for both cattle and sheep.

All well-watered and fenced.

Cattle and sheep handling facilities are available.

Fertiliser details to be confirmed at time of let.

Winter free

Slurry details to be confirmed at time of let.

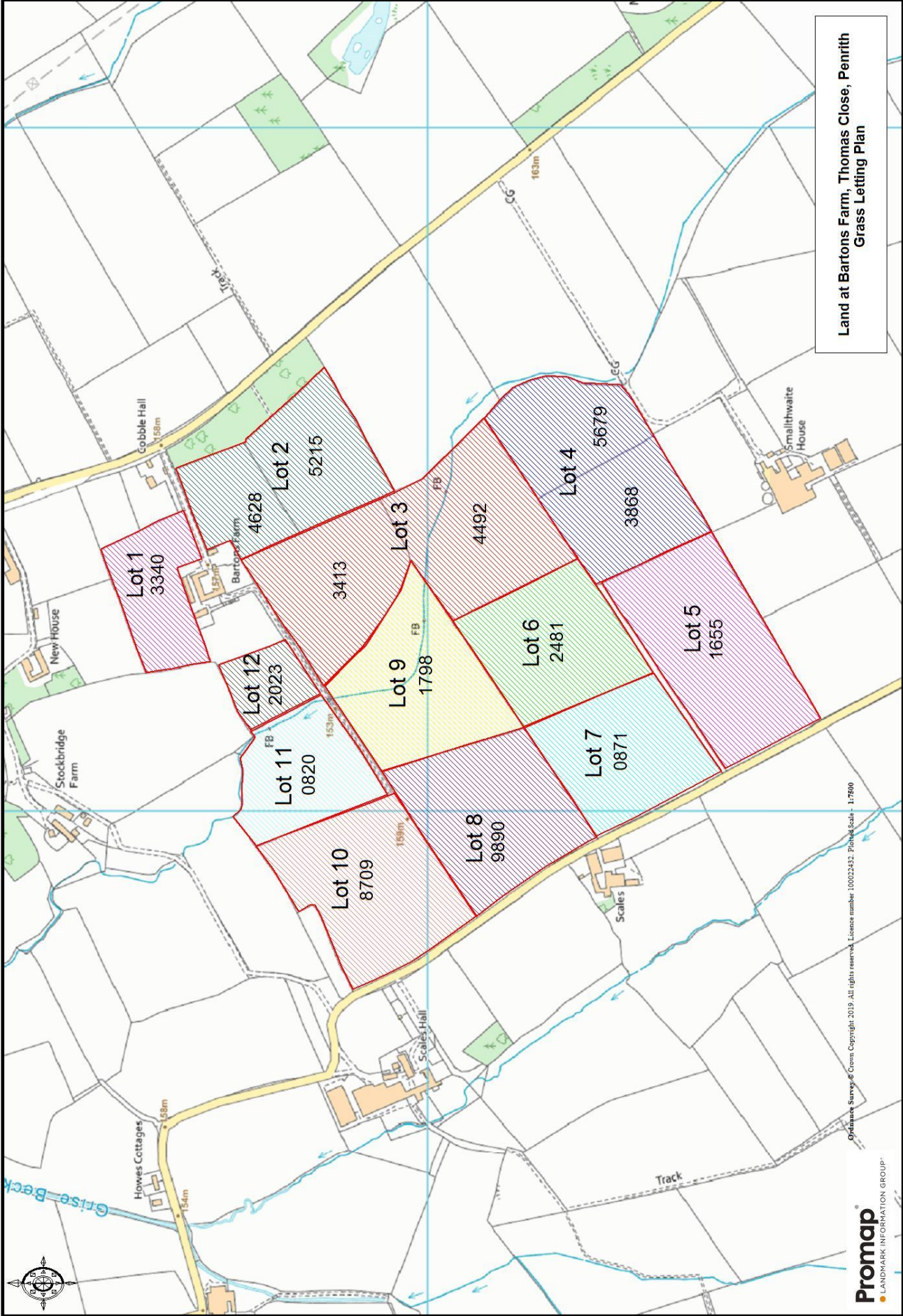

Land at Bartons Farm, Thomas Close, Penrith
Grass Letting Plan

Ordnance Survey © Crown Copyright, 2019. All rights reserved. Licence number 100022432. Printed Scale 1:7500

LETTING OF GRASSLAND ON THE PREMISES

On Friday 11th April 2025

For

Mr N Holliday

Meet at Sewell House at 5.45pm

Lot	Map Sheet	OS	Ha.	Acres
1	NY4042	7056	3.91	9.66
2	NY4042	8473	4.46	11.02
3	NY4042	4199	6.23	15.39
	NY4042	2887	2.88	7.11
	NY4042	2580	<u>2.57</u>	<u>6.35</u>
		TOTAL	11.68	28.85
4	NY4042	5470	8.24	20.36
	NY4042	3365	<u>1.55</u>	<u>3.83</u>
		TOTAL	9.79	24.19
5	NY4042	9149	6.67	16.48
6	NY4042	7493	4.47	11.05
7	NY4042	4309	2.81	6.94

One payment taken on the day of auction.

All lots let from 14th April 2025 – 20th October 2025 for sheep.

All lots let from 25th April 2025 – 30th September 2025 for cattle.

To graze with Cattle and Sheep only, No Bulls, Horses, or Ponies

No mowing of the land.

Fertilizer will be applied by vendor, details at time of let.

No feeding of roughages. Troughs or creep feeders (including lick buckets) may be used and must be moved daily.

Any troughs must be taken well away from gate ways.

All fields are watered, all fences stock proof, takers should satisfy themselves as to the condition of fences and water supply.

Taker to herd own stock

During wet weather conditions herding to be done by ATV or on foot

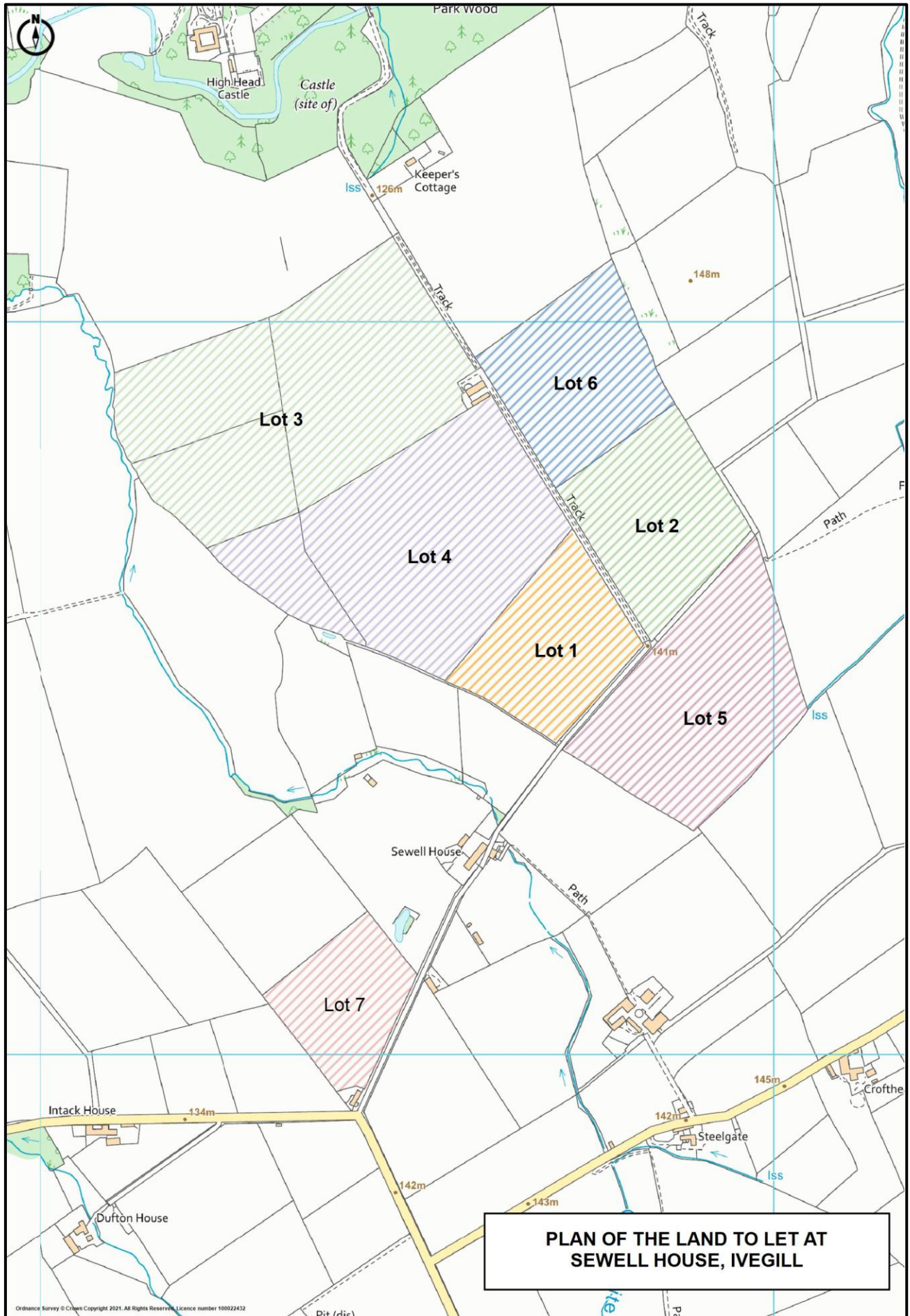

**PLAN OF THE LAND TO LET AT
SEWELL HOUSE, IVEGILL**

LETTING OF GRASSLAND ON THE PREMISES

On Friday 11th April 2025

For

Mr N Holliday

Please meet at Skelton Pasture at 7pm

Lot	Map Sheet	OS	Ha	Acres
1 Fenton Hill	NY4238	4877	7.14	17.64
2 Meadow	NY4238	6585	9.14	22.58
3 Next to Scales Hill	NY4239	9116	10.53	26.02
	NY4238	8483	<u>3.56</u>	<u>8.79</u>
		TOTAL	14.09	34.81
4 Opposite Dixons	NY4339	1205	12.52	30.93
5 Sycamore Field	NY4338	2178	9.86	24.36
6 Mercer Field	NY4338	2855	13.10	32.37
	NY4238	9838	2.85	7.04
	NY4338	5657	<u>0.01</u>	<u>0.02</u>
		TOTAL	15.96	39.43
7 Cottage Field	NY4238	2368	8.58	21.20

Grazing available for both cattle and sheep. The land is let from 12th April 2025 until 21st October 2025.

Winter free.

1.5cwt per acre of fertiliser to be applied

Takers to herd their own stock.

All mains water – Trough charge of £150 per lot

No mowing of the land

No bulls or horses.

No feed troughs.

No supplementary feeding allowed except sheep creep feeders.

No cattle feed blocks or licks allowed.

Handling facilities are available at the farm, lots 4 and 6 have catching pens in the field.

Accidental damage caused to the pens – it is the responsibility of the taker to put right.

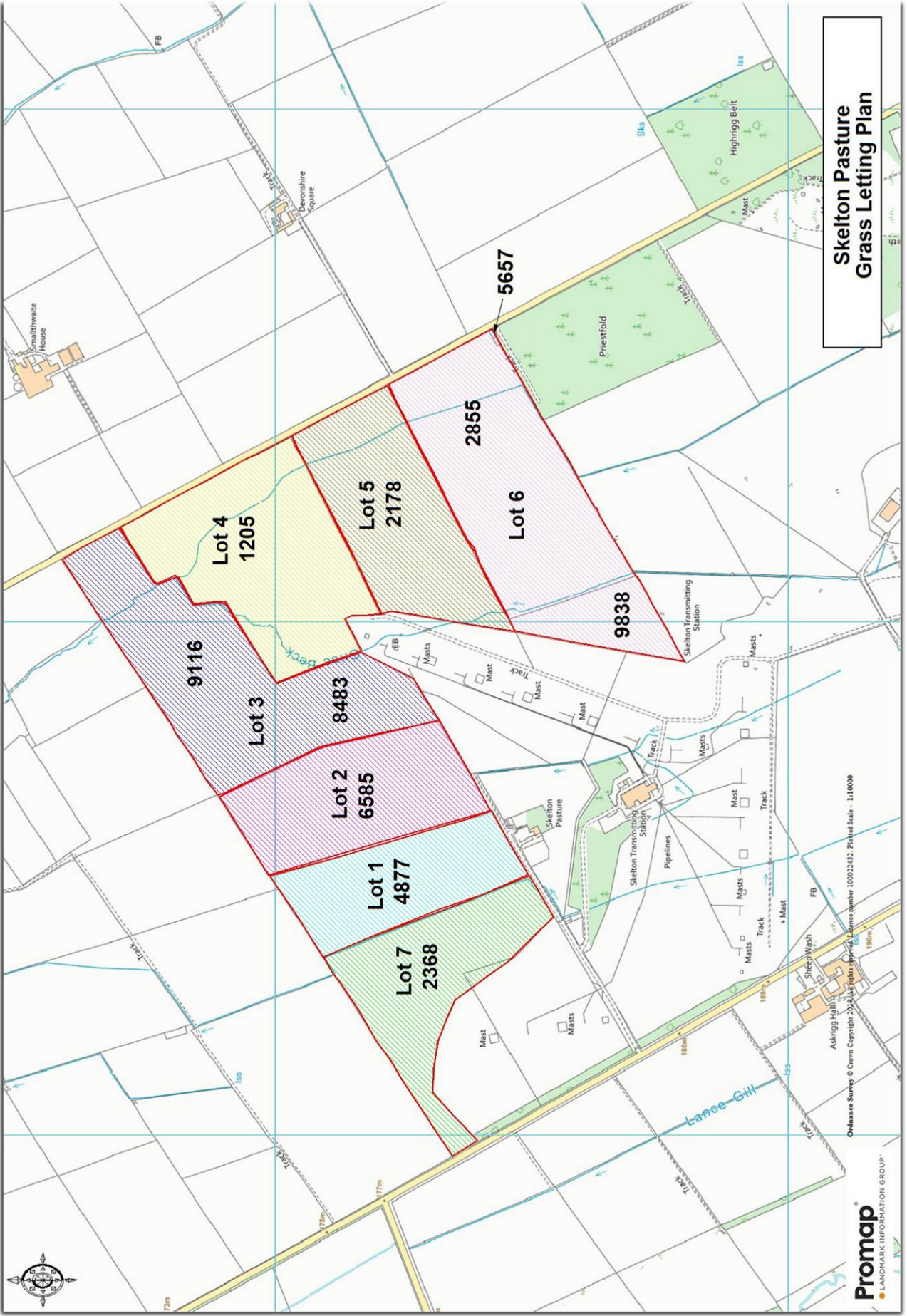

Ordnance Survey © Crown Copyright 2019. All rights reserved. Licence number 100022432. Printed scale - 1:10000



HOPE'S
AUCTIONEERS & LAND AGENTS

Auctioneers & Valuers
serving the Cumbria Agricultural
Community since 1897.



Hopes Auction

Livestock Auctioneers & Valuers

Email: auctioneers@hopesauction.co.uk

Every Tuesday Throughout the Year

Prime Sheep commence at 8:30am
followed by **Ewes**

Every Thursday Throughout the Year

OTM Cattle & Prime Cattle

Prime Bulls to commence at 10:00am
followed by Clean Cattle

OTM Cattle to commence at 10:30am

Alternate Thursdays

Store Cattle & Feeding Bulls

Dairy Cattle, Beef Breeding Cattle,
Calves & Stirks together with Store and
Breeding Sheep

Also special sales as advertised

Please visit our website or contact the office for
more information. All types of agricultural sales
and valuations undertaken.

Hopes Land Agency

T 016973 44901

E landagent@hopesauction.co.uk

- Sales & Letting of Farms & Rural Property
- RICS Red Book Valuations, for all purposes
- Compensation Claims for Electricity, Water & Gas Mains, CPO Road Schemes & Network Rail Access
- Preparation of Grant Scheme & Environmental Stewardship Applications including Sustainable Farming Incentive
- Agricultural Planning Applications & Appraisals including BNG & SCAIL Assessment
- Promotion of Planning & Development Schemes
- Estate Management & Strategic Advice

SCAN HERE



Hope's Auction Co. Ltd.

Syke Road, Wigton, Cumbria, CA7 9NS

T 016973 42202

www.hopesauction.co.uk

DATES FOR YOUR DIARY

SATURDAY 22ND MARCH

SALE OF SMALL TOOLS, IMPLEMENTS & MACHINERY Within the Auction Premises

Sale of Small Tools to commence at 10:30am

Entries Include – International 444 Tractor, Massey Ferguson 165 Tractor, Massey Ferguson 135 Tractor with Loader, Massey Ferguson 80 Loader, Keenan FP100 Feeder Wagon, Low Loader Trailer with Ramps, 10 John Deere Tractor Weights on 3 point linkage frame, Fencing Trailer, Petrol Chainsaw, Ritchie Hydraulic Chain Harrow, Benford TV100 Ride on Roller, Marshall Rotor Spreader, Ritchie Self Loading Round Bale Unwinder, Log Splitter, Diesel Tank with Stand, Hydraulic Rams, Round Bale Squeeze, Cattle Crush, 3 Silage Troughs, Pair of Wheels, Welder mask, Drill & Stand, Leaf Blower, Lawn Mower, Chainsaws, various tools & bolts.

THURSDAY 27TH MARCH 2025

SALE OF PRIME CATTLE & OTM CATTLE FOLLOWED BY SALE OF STORE CATTLE

Sale of Prime Cattle followed by OTM Cattle at 10am
Followed by Store Cattle
Please advise entries to the office
by Friday 21st March at 12 noon

THURSDAY 3RD APRIL 2025

SALE OF PRIME CATTLE & OTM CATTLE FOLLOWED BY SALE OF CALVES & STIRKS, DAIRY CATTLE, & BREEDING SHEEP

Sale of Prime Cattle followed by OTM Cattle at 10am
Followed by Sale of Calves and Stirks at 11am,
Dairy Cattle at 12 noon
Breeding Sheep no sooner than 12.30pm

THURSDAY 10TH APRIL 2025

SALE OF PRIME CATTLE & OTM CATTLE FOLLOWED BY SALE OF FEEDING BULLS AND STORE CATTLE

Please advise entries to the office by Friday 4th April 12 noon



HOPE'S AUCTIONEERS

Auctioneers T: 016973 42202
E: auctioneers@hopesauction.co.uk
Hope's Auction Co. Ltd.
Syke Road, Wigton, Cumbria, CA7 9NS
www.hopesauction.co.uk

NOTICE TO PURCHASERS

Business Trading Terms and Settlement of Purchases
Interest will be chargeable from the date of purchase at 9% over Virgin Money base rate at the time, for accounts in default. Purchases shall be governed by and construed in accordance with the law in England and Scotland.

ACCEPTED PAYMENT METHODS
Direct payment into the bank, debit card, cheque.
2% Surcharge will apply to Business Credit Card payments

Please note that all lots/items must be settled on the day of purchase and prior to clearance of any stock.
For the avoidance of doubt Hopes Auction Co Ltd reserve the right to contra or keep sale proceeds to offset against an outstanding account.

Contacts

David Bowman – 07721 616 786

David Fearon – 07500 173 273

Holding No: 08/040/8003

For additional sales dates, or amendments, please visit our website: www.hopesauction.co.uk
Or follow us on social media @hopesauctioncompany

Note: Maps are NOT to scale.

